

Installation instructions

- Freestanding Tub Faucet Manual

CAREFULLY READ THIS INSTRUCTION MANUAL BEFORE
INSTALLING AND USING THIS PRODUCT

PLEASE KEEP THIS INSTRUCTION MANUAL FOR FUTURE
REFERENCE FOR PRODUCT OPERATION AND MAINTENANCE



BEFORE BEGINNING INSTALLATION

1. Flush plumbing lines to clear any debris.
2. Shut off both supply lines after flushing.

Tools Required



Basin Wrench



Adjustable Wrench



Teflon Tape



Silicone Sealant



Screwdriver

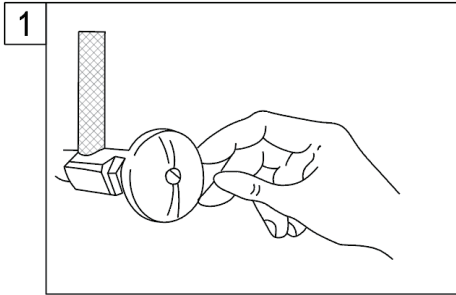

1 Shut off main water supply valve before installation.

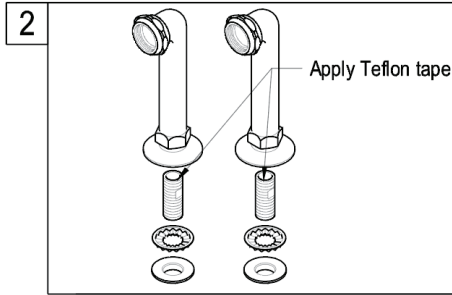

2 Apply Teflon tape on the threads of the copper shank.. Install the risers.

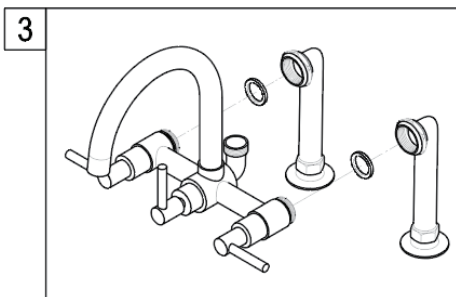

3 Before mounting the faucet onto the supply risers, apply small black washers onto both water inlets of the faucet.

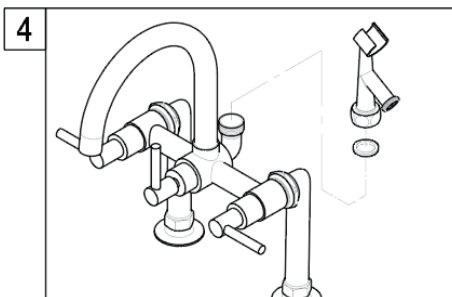

4 Install the shower cradle on top of the faucet body.

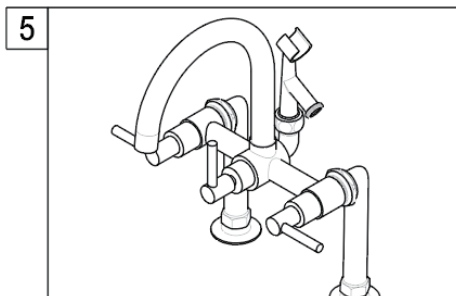

5 Place a washer between the side hole of the shower cradle and the cone nut of the shower hose. Tighten the cone nut.

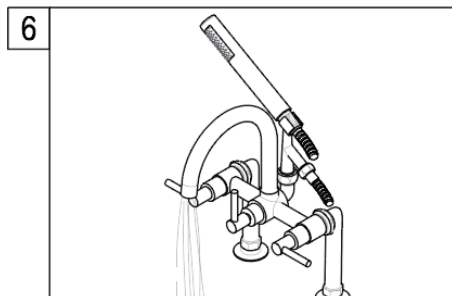

6 Turn on the faucet and let hot and cold water to run for at least one minute to clean any debris inside the water line.

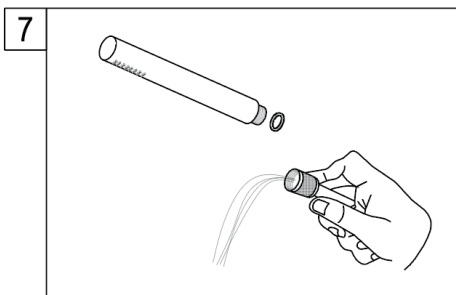

7 Remove shower by unscrewing the shower in a counter clockwise direction, turn on both hot and cold valves and let water run for at least one minute, this will clear any debris.

WARNING!!!

- Do not over-tighten nut during installation.
- Over-tighten may crack the valve and cause severe leak.