

Fixed Aluminum Wall Ladders

05 51 33.13 / PRE
BUYLINE 2268

**Fixed
Aluminum
Wall Ladders**

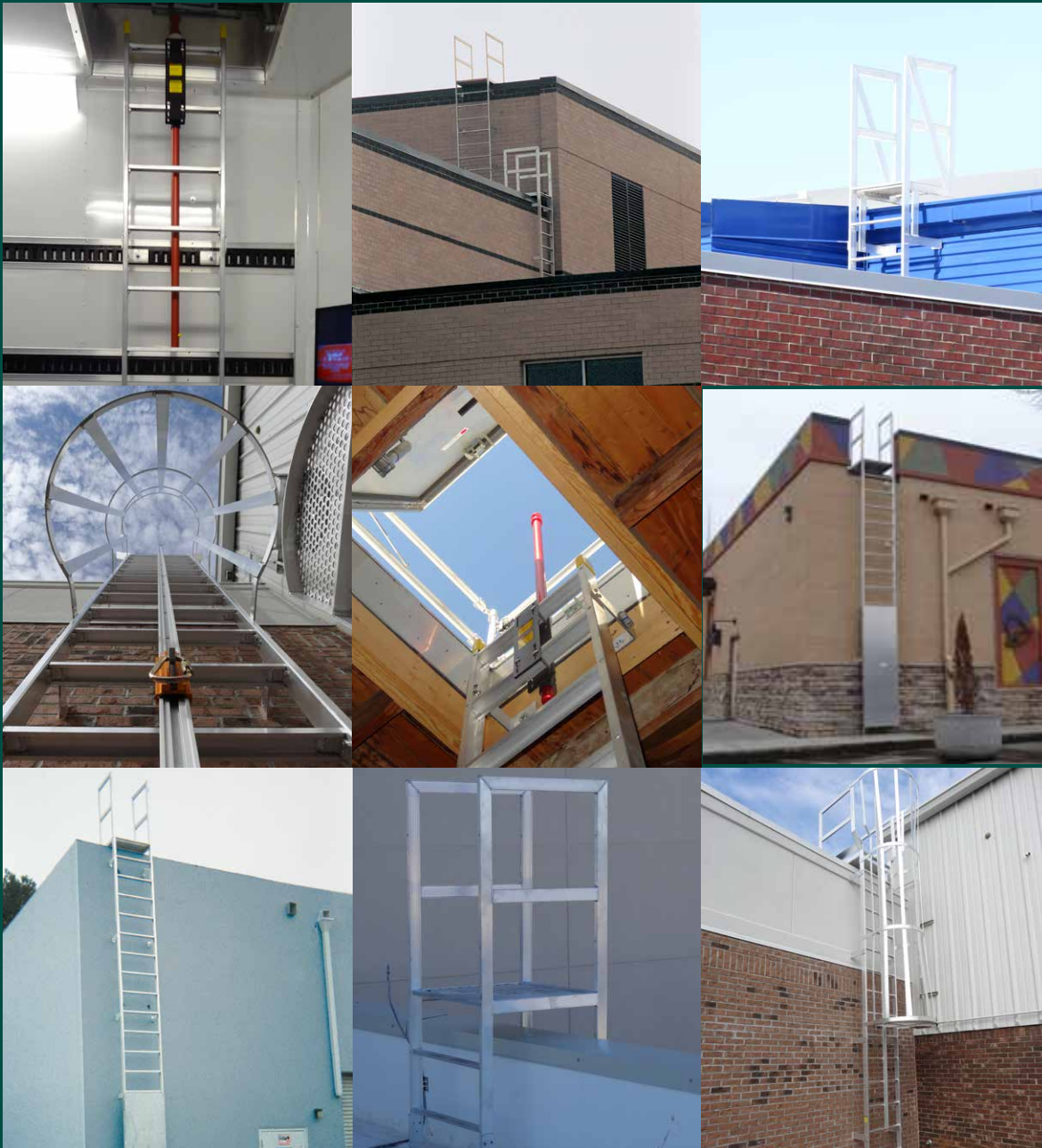

Precision Ladders, LLC

www.PrecisionLadders.com

Precision Ladders, LLC • P.O. Box 2279 • Morristown, TN 37816
Phone: (800) 225-7814 or (423) 586-2265 • Fax: (423) 586-2091
email: laddersales@precisionladders.com www.precisionladders.com



Precision Fixed Aluminum Ladders

Fixed Aluminum Wall Ladders

FIXED LADDER w / WALK-THRU

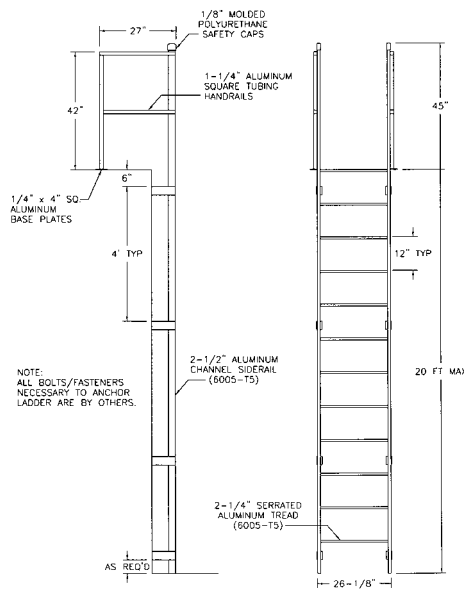

At left: Model FL-XX (XX=vertical height in inches) aluminum ladder with 42" walk through.

At right: Model FL-XX aluminum ladder to roof hatch. Perfect match with a Precision model PH-X roof hatch.

Below right: Example of a caged aluminum ladder with rest platform and 42" walk through side rails. This can be altered to exit at different levels & modified for roof hatch access.

FIXED LADDER TO ROOF HATCH

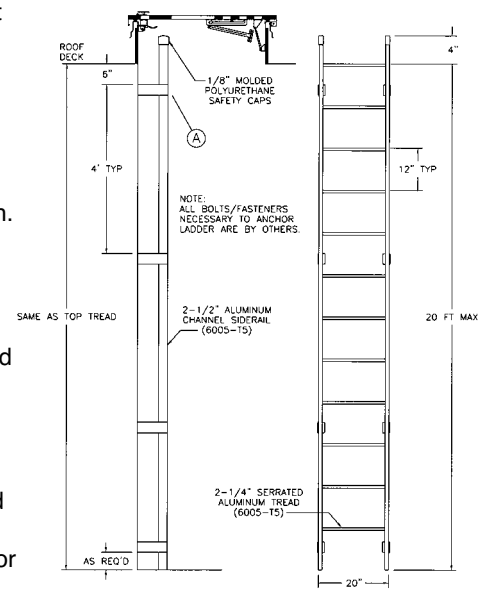

SAFETY

Safety counts, that is why PRECISION ladder treads are a full 2 1/4" in width and deeply serrated to provide maximum traction. Also, all edges on the side rails and treads have been eased (rounded off) to provide a more comfortable, powerful grip.

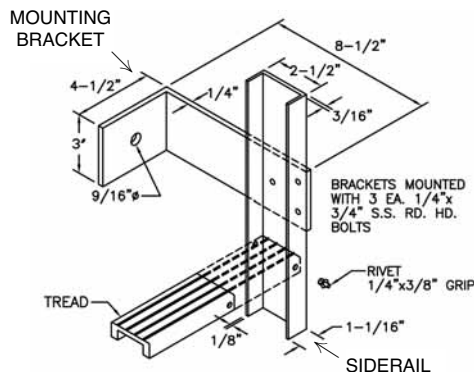

DETAIL "A"

TUBULAR FIXED LADDER w/PARAPET PLATFORM, ROOFSIDE RETURN & FALL ARREST SYSTEM

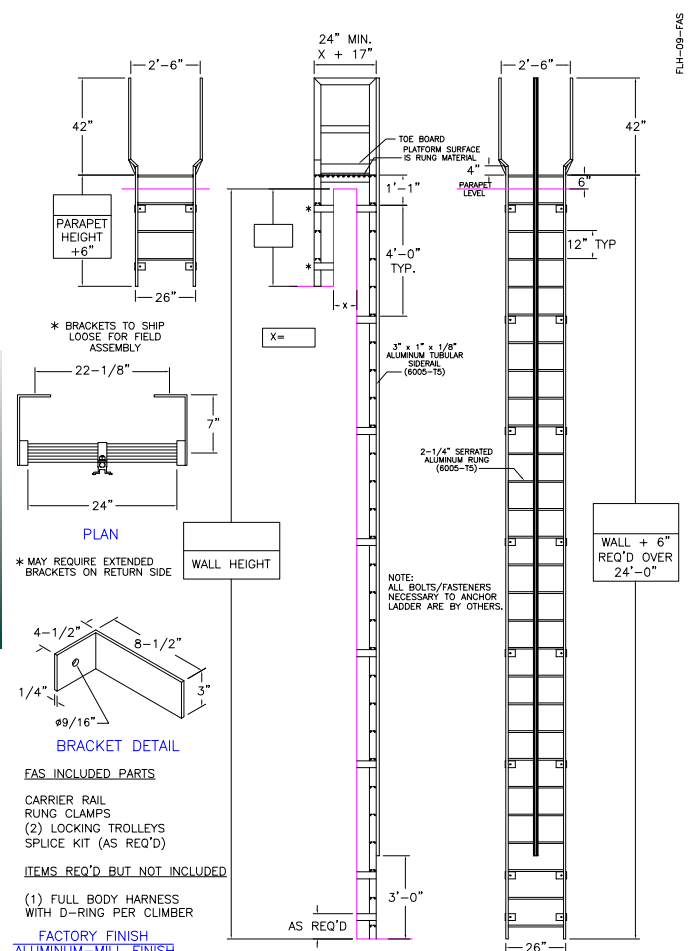

PLAN

* MAY REQUIRE EXTENDED BRACKETS ON RETURN SIDE

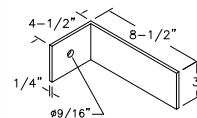

BRACKET DETAIL

FAS INCLUDED PARTS

CARRIER RAIL
RUNG CLAMPS
(2) LOCKING TROLLEYS
SPICE KIT (AS REQ'D)

ITEMS REQ'D BUT NOT INCLUDED

(1) FULL BODY HARNESS
WITH D-RING PER CLIMBER

FACTORY FINISH
ALUMINUM-MILL FINISH

Phone: (800) 225-7814 • Fax: (423) 586-2091
CAD, Revit, and Specification files available
for download at www.precisionladders.com
Consult Factory for custom ladders.

Precision Ladders, LLC
www.PrecisionLadders.com

Precision Tubular Fixed Ladders

In cases where the bracket spacing may be greater than 4 feet or when a heavy duty ladder is required a Precision Model FLH aluminum ladder is used. Tubular Fixed Ladders feature all welded construction. The treads are welded to the siderails.

SIDERAIL DETAIL □

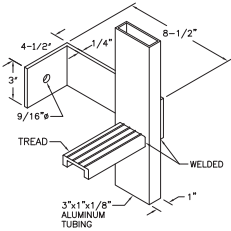

RUNG DETAIL □

1,500 LB LOAD RATING

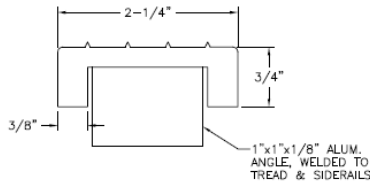

HANDRAILS □
(FIXED VERTICAL LADDER w/WALK-THRU)

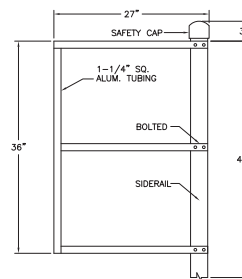

Options For Special Requirements

Safety Cages:

The cage must begin between 7 feet and 8 feet above the base of the ladder. Safety cages are also available to fit existing ladders (steel or aluminum).

Security Measures:

Precision offers a standard aluminum door that closes off the first 7 feet of ladder to prevent unauthorized access. When using a caged ladder, a security gate is the better option. The gate closes the lowest hoop of the cage to ensure only authorized people use the ladder. Both are available for retro fit.

Fall Arrest System:

For protection on ladders using a safety-harness and sleeve mechanism. The product will not allow the climbers to fall more than 6 inches. Required on ladders exceeding 24 feet.

Finishes:

Precision offers all of its aluminum ladders in mill finish (std.), powder coat or finished with clear anodizing.

Other Products Available From Precision

Alternating Tread Stairs



Ships
Stairs

Roof Hatches



**Fixed
Aluminum
Wall Ladders**

Precision Ladders, LLC

www.PrecisionLadders.com



SECTION 05 51 33.13

Fixed Aluminum Wall Ladders

PART 1: GENERAL

1.01 SUMMARY

- A. Aluminum Fixed Vertical Ladder and Components: Ladder, fall arrest system, walk-thru, side rails, cage, rest platforms, floor mounting brackets, security doors, security gates and finishes.
- B. Products required, but not supplied under this section.
1. Required fasteners.

1.02 SYSTEM DESCRIPTION

- A. The system is an aluminum ladder designed to attach to a wall. A fall arrest system is required for ladders exceeding 24 feet. Floor mounting brackets are optional when ladder bottom is at floor level. A safety cap at the top of the stringers is furnished on ladders requiring same. Standard riser height is 12". Ladder shall be able to withstand 1,500 lb. loading without failure.
- B. Security doors and walk-thru side rails can be furnished as an option.

1.03 DELIVERY, STORAGE, AND HANDLING

- A. Examine ladder when it arrives on site. Notify the carrier and manufacturer of any damage.
- B. Store ladder until installation under roof, if possible; or, if stored outside, under a tarp or suitable cover.

1.04 WARRANTY

The ladder carries a limited warranty of five (5) years against defective material and workmanship, covering parts only, no labor or freight. Defective parts, if deemed so by the manufacturer, will be replaced at no charge, freight excluded, upon inspection at manufacturer's plant which warrants same.

1.05 MAINTENANCE

- A. Under normal usage, the ladder shall require no preventive maintenance.
- B. No "spare parts" shall be required.

PART 2: PRODUCTS

2.01 MANUFACTURER

Precision Ladders, LLC
P.O. Box 2279
Morristown, TN 37816
Phone: (800) 225-7814
Fax: (423) 586-2091

2.02 MATERIALS

A. LADDER

1. Stringers (Siderail)
 - 1.1 Aluminum channel. (6005-T5)
 - 1.2 2 1/2" x 1 1/16" x 1/8".
 - 1.3 1/8" molded polyurethane safety caps provided at top.
2. Treads
 - 2.1 Extruded aluminum (6005-T5)
2 1/4" x 3/4" x 1/4".
 - 2.2 Treads deeply serrated for safety.

3. Mounting Bracket

- 3.1 8 1/2" x 4 1/2" x 3" aluminum wall bracket
- 3.2 1/2" x 2" x 3" floor bracket. (Optional)

B. WALK-THRU

1. 1 1/4" aluminum square tube.
2. 4" x 4" x 1/4" aluminum mounting brackets.

C. CAGE

- 1/4" x 2" aluminum flat bar. (6005-T5).

D. REST PLATFORM

1. 30" x 48" standard. (Larger sizes optional)
2. Bar Grating surface standard.
3. Aluminum toe boards. (6005-T5).

E. SECURITY OPTIONS

1. 1/8" aluminum door (3003-H14). (Optional)
2. Hinged gate at bottom of cage. (Optional)

F. SAFETY

1. 42" handrail at platforms.
2. Fall arrest system for protection of personnel. Required on ladders 24 feet or higher.

G. MANUFACTURED UNITS

The Fixed Vertical Ladder is a Model FL-**. (** Total level to level in inches)

H. ACCESSORIES

None

I. FABRICATION

1. The ladder is completely fabricated and ready for installation before shipment to the site.
2. Any walk-thru, cages, platforms, and security doors are completely fabricated and ready for field attachment to the ladder before shipment to the site.

J. FINISHES

1. Mill finish on aluminum ladder components.
2. Finish options include powder coat or anodized. (Optional).

PART 3: EXECUTION

3.01 INSTALLATION

Install in accordance with approved submittals.

3.02 FIELD QUALITY CONTROL

The manufacturer has representatives in all areas of the United States and Canada. For the name of the closest representative, call (800) 225-7814.

Note: When a heavy duty Tubular Ladder is required consult factory for specification details.