

TUBULAR LADDER w/CANTILEVER PLATFORM & FALL ARREST SYSTEM

(FALL ARREST SYSTEM REQUIRED IF LEVEL TO LEVEL HEIGHT IS GREATER THAN 24'-0")

FLH-14-FAS

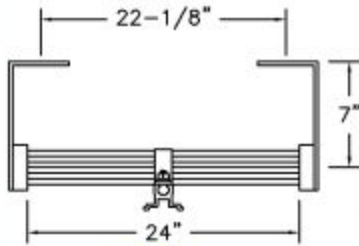

PLAN

(HANDRAILS OMITTED FOR CLARITY)

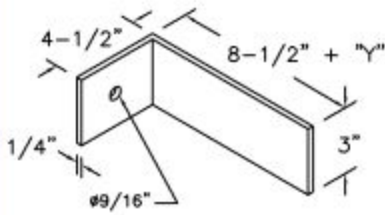

BRACKET DETAIL

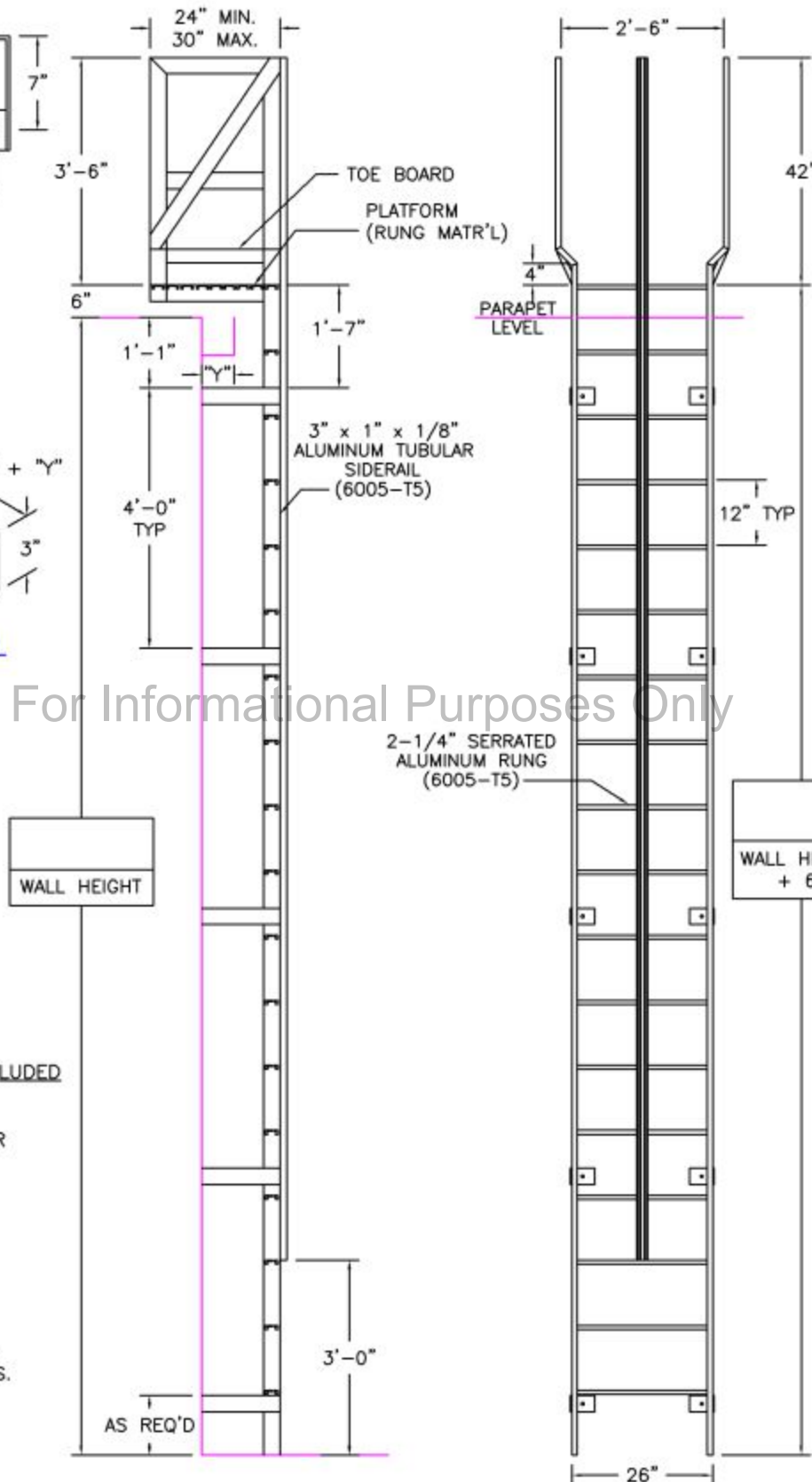

FAS INCLUDED PARTS

CARRIER RAIL
RUNG CLAMPS
(2) LOCKING TROLLEYS
SPICE KIT (AS REQ'D)

ITEMS REQ'D BUT NOT INCLUDED

(1) FULL BODY HARNESS
WITH D-RING PER CLIMBER

NOTE:
ALL BOLTS/FASTENERS
NECESSARY TO ANCHOR
LADDER ARE BY OTHERS.

FACTORY FINISH
ALUMINUM-MILL FINISH

LADDER RATED AT 1,500 LBS

PROJECT		PRECISION REP	
DATE	PURCHASER	DATE	SERIAL#
DATE 2/21/19	MODEL#	DATE	QTY.
ARCH'T OR ENGR.		FLH=	
PURCHASE ORDER		DNH	
BUILT BY:		CHECKED BY:	
DRAWN BY:		WORK ORDER: ()	

LADDERS MANUFACTURED BY PRECISION LADDERS, LLC
COMPLY WITH OSHA 1910 SUBPART D AND ANSI 14.3

Precision Ladders, LLC

P.O. BOX 2279 Morristown, TN 37816-2279
Ph: (423) 586-2265 Fax: (423) 586-2091
www.PrecisionLadders.com



For Informational Purposes Only