

INSTALLATION INSTRUCTIONS

Tools Needed

• Wrench • Pencil • Tape Measure • Plumbers Putty • Screwdriver

Be sure to re-inforce wall before installation. We recommend a 2"x12" securely fastened to wall studs at desired height for your installation.

Cast Iron Wall Mount Sink with & without Legs

Steps:

1. Make sure to have proper wood blocking to support weight of sink in the wall.
2. Determine the optimal height.
3. Heavy leg bolts recommended (do not use dry wall screws)
4. Mount the wall bracket to the desired position on the wall (See Image A)
5. Be sure to tighten brackets that are preinstalled to the back of sink.
6. Attach sink brackets to the wall brackets.
7. See preinstalled leg mounts underneath sink. (See Image B)
8. Place leg into position and slide bolt through leg mounts.
9. Check that legs are secured to bottom of the sink.
10. Bottom feet of legs screw in and out to make the sink level.

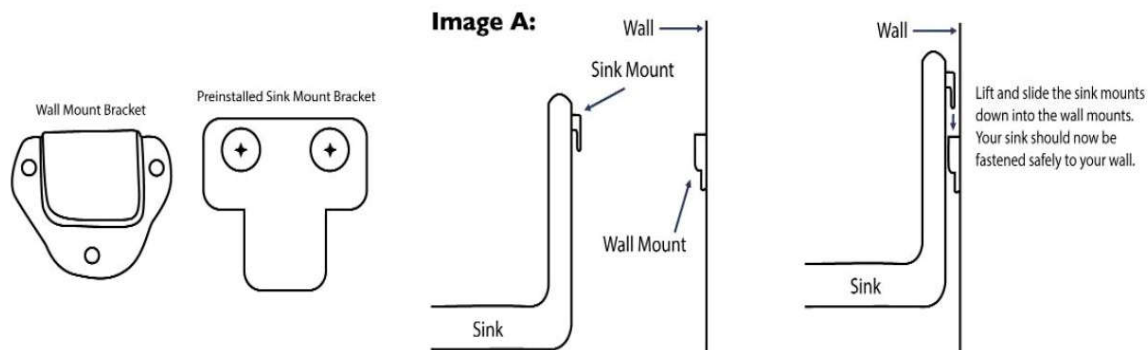

Image B:

