



OFFICE OF PROCUREMENT

Marc Elrich
County Executive

Avinash G. Shetty
Director

**MONTGOMERY COUNTY GOVERNMENT
SOLICITATION AMENDMENT NO. 1
IFB NO. 1103283
July 3, 2019**

PAGE 1 OF 5 FOR THE PROCUREMENT OF: **Montclair Manor Community Lighting and Site Improvements Project**

ALL SOLICITATION AMENDMENTS MUST BE ACKNOWLEDGED BY THE BIDDER PRIOR TO THE HOUR AND DATE SPECIFIED IN THE SOLICITATION (AS AMENDED) FOR RECEIPT OF BIDS. FAILURE TO ACKNOWLEDGE AN AMENDMENT MAY BE CAUSE TO REJECT THE BID.

DESCRIPTION OF AMENDMENT: The attention of prospective bidders is directed to the following additions and revisions.

The correction of electrical items shown on the plans and in the Invitation for Bids

Invitation for Bids Specification Book

Page 271

Item 15 - Furnish and Install Connector Kit Type II - Quantity is changed to **32**

Page 272

Item 16 - Furnish and Install Connector Kit Type III - Quantity is changed to **36**

Please replace with revised pages 271 & 272

Plans

Sheet 8 of 12 – EQUIPMENT SCHEDULE

Category 834002 Connector Kit – Type II should be 20 Ea.

Category 834003 Connector Kit – Type III should be 26 Ea.

Insurance Requirements

The contractor that is awarded the project must list the Montclair Manor Homeowner’s Association as an additional insured in addition to the language for Montgomery County as shown under “Additional Insured” on page 32 of the IFB Specification book.

THERE ARE NO OTHER CHANGES

SIGNATURE PAGE FOLLOWS

Office of Procurement

255 Rockville Pike, Suite 180 • Rockville, Maryland 20850 • 240-777-9900 • 240-777-9956 TTY • 240-777-9952 FAX
www.montgomerycountymd.gov

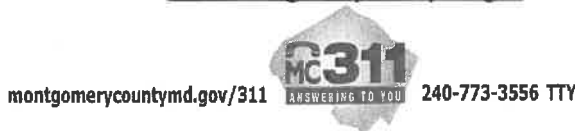

Solicitation Amendment No.1
Bid No. 1103283
Montclair Manor Community Lighting and Site Improvements Project

THIS SOLICITATION PROVISION ENTITLED "SOLICITATION AMENDMENTS" IS APPLICABLE TO THIS AMENDMENT.
THE CHANGES SET FORTH BELOW ARE HEREBY INCORPORATED INTO THE ABOVE-CITES SOLICITATION. THE HOUR
AND STATE SPECIFIED FOR RECEIPT OF OFFERS IS NOT EXTENDED.

ISSUED BY:

Avinash Shetty, Director
Office of Procurement

NAME OF OFFEROR: _____
(Type or Print)

NAME AND TITLE OF PERSON
AUTHORIZED TO SIGN: _____
(Type or Print)

OFFEROR'S SIGNATURE: _____ Date: _____

MONTCLAIR MANOR COMMUNITY LIGHTING AND SITE IMPROVEMENTS PROJECT

Notice to Bidders: This proposal shall be filled by the bidder, with the prices written in numerals, and the extensions shall be made by the bidder. In the event of a discrepancy between the unit prices and the extensions (product of the quantity and unit price), the unit price will govern. This applies to all items (1-31) in this schedule of prices. For complete information concerning these items, see Specifications, General and Specific Provisions and Contract Forms. Contingent items will be denoted with an asterisk (*).

ELECTRICAL

ITEM	APPROXIMATE QUANTITY		DESCRIPTION OF ITEMS	UNIT PRICE		EXTENDED PRICE	
				Dollars	Cts	Dollars	Cts
6	34	EA	Furnish and Install 12' Decorative Light Pole	\$		\$	
7	17	CY	Furnish and Install Concrete for Light Foundation	\$		\$	
8	34	EA	Furnish and Install LED Roadway Luminaire (30 W LED)	\$		\$	
9	1	EA	Furnish and Install 200 AMP Base Mounted Metered Service Panel	\$		\$	
10	4	EA	Furnish and Install Junction Box	\$		\$	
11	4300	LF	Furnish and Install Duct Cable – 2 Conductor, No 6 AWG, 600V	\$		\$	
12	160	LF	Furnish and Install Cable – 1 Conductor, No. 6 AWG Use 600V	\$		\$	
13	4750	LF	Furnish and Install Bare Copper Ground Wire No. 6 AWG	\$		\$	
14	20	LF	Furnish and Install 2 Inch Diameter Rigid Steel Conduit, Schedule 40	\$		\$	
15	32	EA	Furnish and Install Connector Kit – Type II	\$		\$	

MONTCLAIR MANOR COMMUNITY LIGHTING AND SITE IMPROVEMENTS PROJECT

Notice to Bidders: This proposal shall be filled by the bidder, with the prices written in numerals, and the extensions shall be made by the bidder. In the event of a discrepancy between the unit prices and the extensions (product of the quantity and unit price), the unit price will govern. This applies to all items (1-31) in this schedule of prices. For complete information concerning these items, see Specifications, General and Specific Provisions and Contract Forms. Contingent items will be denoted with an asterisk (*).

ELECTRICAL (con't)

ITEM	APPROXIMATE QUANTITY		DESCRIPTION OF ITEMS	UNIT PRICE		EXTENDED PRICE	
				Dollars	Cts	Dollars	Cts
16	36	EA	Furnish and Install Connector Kit – Type III	\$		\$	
17	20	EA	Furnish and Install Connector Kit – Type VI	\$		\$	
18	34	EA	Furnish and Install Ground Rod – 3/4 Inch Diameter x 10 Foot Length	\$		\$	
19	1	EA	Furnish and Install Remote Lighting Cabinet 60 AMP	\$		\$	
				\$		\$	
				\$		\$	
				\$		\$	
				\$		\$	
				\$		\$	
				\$		\$	
				\$		\$	
				\$		\$	
				\$		\$	
			TOTAL ELECTRICAL COSTS	\$		\$	

NUMBER	REVISION	DATE	INITIALS
1	LIGHTING ITEM QUANTITIES	07/01/2019	FJS

CATEGORY CODE	DESCRIPTION	UNIT	QUANTITY
80103	CONCRETE FOR LIGHT FOUNDATION	CY	11.5
82500	BARE COPPER WIRE NO 6 AWG	LF	2000
80025	LED ROADWAY LUMINAIRE	EA	23
80000	12 FOOT DECORATIVE POLE	EA	23
82601	DUCT CABLE - 2 CONDUCTOR NO 6 AWG USE 600V	LF	2600
82016	CONDUCTOR NO 6 AWG TYPE I	LF	80
80701	GROUND ROD - 3/4 INCH DIAMETER 10 FOOT LENGTH	EA	23
83402	CONNECTOR KIT - TYPE II	EA	23
83403	CONNECTOR KIT - TYPE III	EA	23
83404	CONNECTOR KIT - TYPE IV	EA </td <td>12</td>	12
91001	JUNCTION BOX	EA	3

- NOTES:**
- NO. 6 CONCRETE CONVEHATION INCLUDES ALL CONCRETE EXCAVATION REINFORCEMENT STEEL ANCHOR BOLTS BACKFILL MATERIAL LABOR EQUIPMENT AND TOOLS TO COMPLETE THE WORK
 - CABLE AND GROUND WIRE CONVEHATION INCLUDES ALL EXCAVATION BACKFILL MATERIAL LABOR EQUIPMENT AND TOOLS TO COMPLETE THE WORK
 - JUNCTION BOX INCLUDES ALL EXCAVATION BACKFILL MATERIAL LABOR EQUIPMENT AND TOOLS TO COMPLETE THE WORK
 - CABLE FROM CONTROL CABINET TO JUNCTION BOX SHALL BE INSTALLED IN EXISTING CONDUIT CONDUIT SHALL BE 1/2" RIGID PVC CONDUIT MISSING WOOD FENCE SLATS SHALL BE INCIDENTAL TO THE COST OF CABLE

GENERAL NOTES:
1 SEE GENERAL NOTES ON SHEET LT-01, SHEET 7

LOCATION	TYPE I	TYPE II	TYPE III	TYPE IV
L-1	0	0	0	4
L-2	0	0	0	4
L-3	0	0	0	4
L-4	0	0	0	4
A-1	2	0	0	0
A-2	0	2	0	0
A-3	0	2	0	0
A-4	0	2	0	0
A-5	0	2	0	0
A-6	0	2	0	0
A-7	2	0	0	0
A-8	0	2	0	0
A-9	2	0	0	0
B-1	2	0	0	0
B-2	0	2	0	0
B-3	0	2	0	0
B-4	0	2	0	0
B-5	0	2	0	0
B-6	0	2	0	0
B-7	2	0	0	0
C-1	2	0	0	0
C-2	0	2	0	0
C-3	0	2	0	0
C-4	2	0	0	0
D-1	2	0	0	0
D-2	0	2	0	0
D-3	2	0	0	0

KEY NOTES:
 [] EXISTING ELECTRICAL SERVICE PANEL WITH PHOTOCELL FOR "A" AND "B" CIRCUITS INSTALL NEW CIRCUIT BREAKERS
 [] EXISTING ELECTRICAL SERVICE PANEL WITH PHOTOCELL FOR "C" AND "D" CIRCUITS INSTALL NEW CIRCUIT BREAKERS

CIRCUIT NUMBER	CONDUCTOR SIZE	EXISTING METERED SERVICE PANEL SCHEDULE - 3086 CLARIDGE CT		REMARKS
		NO. OF POLES	TRIP SIZE	
1	NO 6 AWG	2	20	(9) - 20 W LED LUMINAIRES
2	NO 6 AWG	2	20	(7) - 20 W LED LUMINAIRES
3	NO 6 AWG	1	20	GF
4	NO 6 AWG	1	20	UNKNOWN
5	NO 6 AWG	1	20	UNKNOWN

CIRCUIT NUMBER	CONDUCTOR SIZE	EXISTING METERED SERVICE PANEL SCHEDULE - 3223 CLARIDGE CT		REMARKS
		NO. OF POLES	TRIP SIZE	
1	NO 6 AWG	2	20	(4) - 20 W LED LUMINAIRES
2	NO 6 AWG	2	20	(5) - 20 W LED LUMINAIRES
3	NO 6 AWG	1	20	UNKNOWN
4	NO 6 AWG	1	20	UNKNOWN
5	NO 6 AWG	1	20	UNKNOWN

EQUIPMENT	TYPE
A-5, A-6, A-7	OVHSS160
B-5, B-6, B-7	OVHSS160
D-2	OVHSS160

REPLACEMENT OF WOOD SLATS IN EXISTING FENCE
 LOCATION: WESTERN EDGE OF PROPERTY
 QUANTITY: EACH
 NOTE: INDICATED BY THE ESTIMATE AS A COMMENT ITEM TOTAL NUMBER OF REPLACEMENT SLATS TO BE DETERMINED IN FIELD

ITEM	DESCRIPTION
(A)	82201 DUCT CABLE - 2 CONDUCTOR, NO 6 AWG 600V
(B)	82016 CABLE - 1 CONDUCTOR NO 6 AWG TYPE USE
(C)	82220 BARE COPPER WIRE NO 6 AWG

- LEGEND:
 [] PROPOSED LIGHT POLE AND LUMINAIRE
 [] INDICATOR FOR DIRECTION OF LIGHT
 [] GROUNDING ROD
 [] CABLE RUN
 [] JUNCTION BOX
 [] ELECTRIC METER

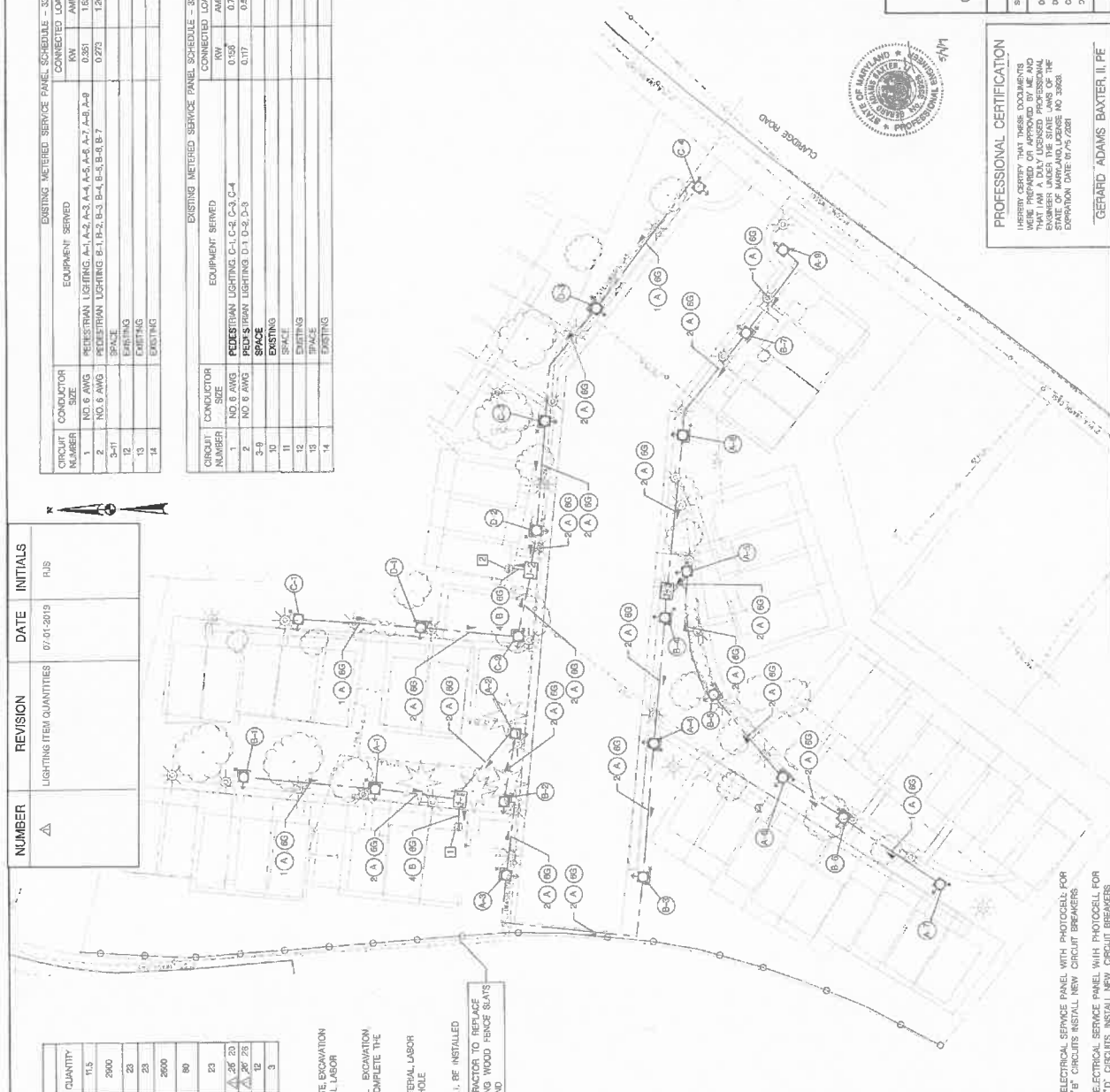

PROFESSIONAL CERTIFICATION
 I HEREBY CERTIFY THAT THESE DOCUMENTS WERE PREPARED OR APPROVED BY ME AND I AM A LICENSED PROFESSIONAL ENGINEER UNDER THE STATE LAWS OF THE STATE OF MARYLAND, LICENSE NO. 39628 EXPIRATION DATE 07/17/2021
 GERARD ADAMS BAXTER, II, PE

MONTGOMERY COUNTY
 DEPARTMENT OF HOUSING AND COMMUNITY AFFAIRS
 COMMUNITY LIGHTING AND SITE IMPROVEMENTS
 ROADWAY AND LIGHTING PLAN
 SCALE: 1" = 30' CONTRACT NO. _____
 DESIGNED BY: _____ COUNTY: MONTGOMERY COUNTY
 DRAWN BY: _____ LOCAL: _____
 CHECKED BY: _____ DATE: _____
 DATE: _____ SCALE: 1" = 30'
 DRAWING NO. LT-02 OF 02 SHEET NO. 8 OF 12



BY: S. Shrininger